

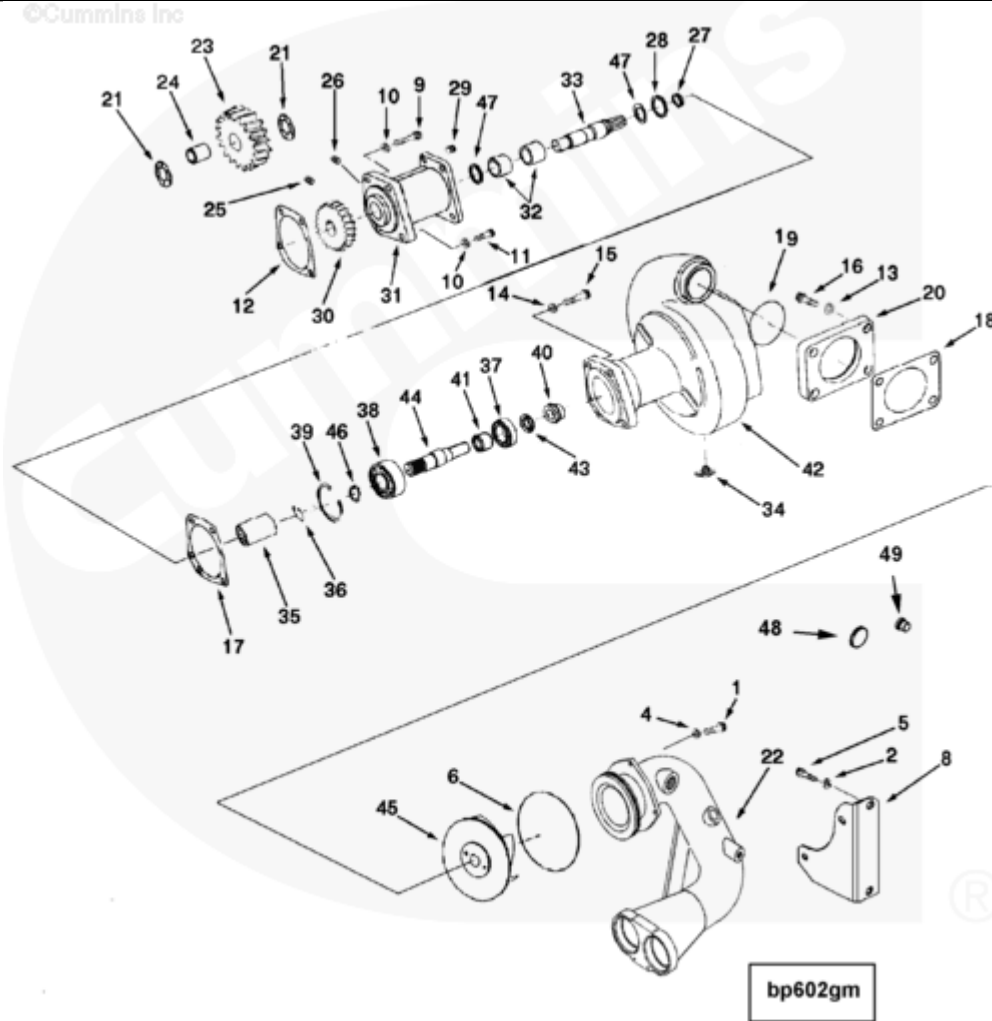

## Parts Catalog - Option Detail

| Electronic Parts Catalog - Option Detail |   |         |           |           |
|--|---|---------|-----------|-----------|
| Option                                   | Group   | Graphic | Film Card | Date      |
| BP6110-06                                | 08.01   | bp602gm | K38       | 02-AUG-04 |
| <b>Engines</b>                           | GTA38, K38, KTA38GC CM558, QSK38 CM2150 K106, QSK38 CM2150 MCRS, QSK38 CM850 MCRS |         |           |           |



[SMALL](#) | [MEDIUM](#) | [LARGE](#)

| Cart  | Ref No | Part Number               | Part Description         | Required | Remarks              |
|---|--------|---------------------------|--------------------------|----------|----------------------|
| <input type="button" value="View My Cart"/> |        |                           |                          |          |                      |
|   |        | <a href="#">BP6110-06</a> | Water Pump               |          |                      |
| <input type="checkbox"/>                    | 1      | <a href="#">3010596</a>   | Captive Washer Cap Screw | 4        | 3/8 - 16 x 1 1/4 in. |
|   | 2      | <a href="#">S 604</a>     | Lock Washer              | 2        | 3/8 in.              |

|                          |    |         |                        |   |                             |
|--------------------------|----|---------|------------------------|---|-----------------------------|
| <input type="checkbox"/> |    |         |                        |   |                             |
| <input type="checkbox"/> | 4  | 108330  | Plain Washer           | 4 | 3/8 in.                     |
| <input type="checkbox"/> | 5  | 108707  | Hexagon Head Cap Screw | 2 | 3/8 - 16 x 1 1/2 in.        |
| <input type="checkbox"/> | 6  | 206457  | O-Ring Seal            | 1 |                             |
| <input type="checkbox"/> | 8  | 3175857 | Water Pump Support     | 1 |                             |
| <input type="checkbox"/> | 9  | S 162 A | Hexagon Head Cap Screw | 3 | 7/16 - 14 X 2 3/4 in.       |
| <input type="checkbox"/> | 10 | S 610   | Lock Washer            | 4 | 7/16 in.                    |
| <input type="checkbox"/> | 11 | 103009  | Hexagon Head Cap Screw | 1 | 7/16 - 14 X 1 1/4 in.       |
| <input type="checkbox"/> | 12 | 206416  | Support Gasket         | 1 |                             |
| <input type="checkbox"/> | 13 | S 604   | Lock Washer            | 4 | 3/8 in.                     |
| <input type="checkbox"/> | 14 | S 610   | Lock Washer            | 4 | 7/16 in.                    |
| <input type="checkbox"/> | 15 | 103009  | Hexagon Head Cap Screw | 4 | 7/16 - 14 X 1 1/4 in.       |
| <input type="checkbox"/> | 16 | 199919  | Twelve Point Cap Screw | 4 | 3/8 - 16 X 1 1/2 Inch.      |
| <input type="checkbox"/> | 17 | 206193  | Water Pump Gasket      | 1 |                             |
| <input type="checkbox"/> | 18 | 206455  | Water Pump Gasket      | 1 |                             |
| <input type="checkbox"/> | 19 | 3007512 | O-Ring Seal            | 1 |                             |
| <input type="checkbox"/> | 20 | 3008494 | O-Ring Adapter         | 1 |                             |
| <input type="checkbox"/> | 21 | 130083  | Thrust Bearing         | 2 |                             |
| <input type="checkbox"/> | 22 | 3632825 | Water Inlet Connection | 1 |                             |
| <input type="checkbox"/> | 23 | 3628822 | Idler Gear             | 1 |                             |
| <input type="checkbox"/> | 24 | 3004686 | Bushing                | 1 |                             |
| <input type="checkbox"/> |    | 3634065 | Water Pump Support     | 1 | Recon equivalent 3634065 NX |
| <input type="checkbox"/> | 25 | 68193   | Pipe Plug              | 1 | 1/8 NPT                     |
|                          | 26 | 3631805 | Pipe Plug              | 1 |                             |
|                          | 27 | 3627723 | Shaft Retainer         | 1 |                             |
| <input type="checkbox"/> | 28 | 3026556 | Thrust Bearing         | 1 |                             |
| <input type="checkbox"/> | 29 | 3634019 | Expansion Plug         | 1 |                             |
|                          | 30 | 207251  | Water Pump Gear        | 1 |                             |
|                          | 31 | 3634066 | Water Pump Support     | 1 |                             |
| <input type="checkbox"/> | 32 | 3629855 | Bushing                | 2 |                             |

|                          |    |                         |                        |   |          |
|--------------------------|----|-------------------------|------------------------|---|----------|
|                          | 33 | <a href="#">3628187</a> | Water Pump Shaft       | 1 |          |
| <input type="checkbox"/> | 35 | <a href="#">206195</a>  | Spline Coupling Sleeve | 1 |          |
| <input type="checkbox"/> | 36 | <a href="#">206196</a>  | Retaining Ring         | 1 |          |
| <input type="checkbox"/> |    | <a href="#">3635807</a> | Water Pump             | 1 |          |
| <input type="checkbox"/> | 34 | <a href="#">S 962 E</a> | Draincock              | 1 |          |
| <input type="checkbox"/> | 37 | <a href="#">S 16054</a> | Ball Bearing           | 1 |          |
| <input type="checkbox"/> | 38 | <a href="#">S 16069</a> | Ball Bearing           | 1 |          |
| <input type="checkbox"/> | 39 | <a href="#">70183</a>   | Retaining Ring         | 1 |          |
| <input type="checkbox"/> | 40 | <a href="#">3634146</a> | Oil Seal               | 1 |          |
| <input type="checkbox"/> | 41 | <a href="#">3030487</a> | Bearing Spacer         | 1 |          |
| <input type="checkbox"/> | 42 | <a href="#">3635713</a> | Water Pump Body        | 1 |          |
| <input type="checkbox"/> | 43 | <a href="#">3634007</a> | Water Pump Seal        | 1 |          |
| <input type="checkbox"/> | 44 | <a href="#">3634049</a> | Water Pump Shaft       | 1 |          |
| <input type="checkbox"/> | 45 | <a href="#">3050453</a> | Water Pump Impeller    | 1 |          |
| <input type="checkbox"/> | 46 | <a href="#">3175573</a> | Retaining Ring         | 1 |          |
| <input type="checkbox"/> | 47 | <a href="#">3026556</a> | Thrust Bearing         | 2 |          |
| <input type="checkbox"/> | 48 | <a href="#">3004259</a> | Expansion Plug         | 1 |          |
| <input type="checkbox"/> | 49 | <a href="#">3008466</a> | Pipe Plug              | 1 | 1/4 NPT. |